



The following page(s) are extracted from multi-page Kuhnke product catalogues or CDROMs and any page number shown is relevant to the original document. The PDF sheets here may have been combined to provide technical information about the specific product(s) you have selected.

Hard copy product catalogues, and CDROMs have been published describing Kuhnke Pneumatics, Solenoids, Relays and Electronics; some divided into different books. A list of current publications is available on this web site or from our sales offices. Some may be available for download, but as substantially larger files.

Contact Details

Kuhnke sales and service in North America

Ellis/Kuhnke Controls
132 Lewis Street
Unit A-2, Eatontown
NJ 07724
USA

T: (800) 221 0714
T: (732) 291 3334
F: (732) 291 8154

Important Note

The information shown in these documents is for guidance only. No liability is accepted for any errors or omissions. The designer or user is solely responsible for the safe and proper application of the parts, assemblies or equipment described.

Logic Valves and Flow Controls

Series 47

Kuhnke System Logic Devices

AND/OR Logic Valves



47002 AND Valve (Dual Pressure)

47003 OR (Shuttle) Valve

And valve opens when pressure is present at both inlet ports. **Or** valve opens when pressure is present at either inlet port. Design uses piston construction, providing smooth output flow.

Flow: 7 CFM @ 100 PSI

Min. Op. Pressure: 15 PSI.

Through Body Mtg. Holes:
1/8" dia. on 11/16" centers.

Dimensions: 1" H x 7/8" W x 1/2" D.

Ports: 10-32 (M5)

Material: Anodized Aluminum Housing

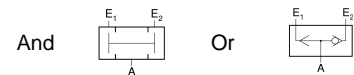

Check Valve (Non Return)



47260

In line mounted, valve allows for flow in one direction only. Arrow on body shows direction of flow.

Flow: 8 CFM @ 100 PSI

Operation: Opens at 7 PSI

Dimensions: 1 3/16" L x 3/8" Hex.

Ports: 10-32 (M5)

Material: Brass

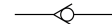

Quick Exhaust Valve

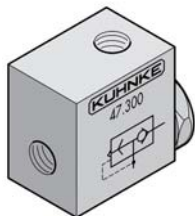

47300

In line mounted, outlet port exhausts directly to atmosphere at loss of inlet pressure.

Dimensions:

11/16" H x 13/16" W x 1/2" D.

Ports: 10-32 (M5)

Material: Brass

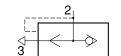

Non Adjustable One Way Flow Control



47251- **

Mounts directly in port of valve or cylinder. Various fixed orifices reduce flow to a low and constant value. Check valve prevents flow in reverse direction.

Available with .10/.16/.25/.40/.60mm orifices. Add aperture size to catalog number.

Flow @ 100 PSI:

**** .10** - .012 CFM

**** .16** - .05 CFM

**** .25** - .12 CFM

**** .40** - .3 CFM

**** .60** - .7 CFM

Check Valve: opens at 7 PSI

Dimensions: 1 5/8" H. x 1/4" Hex.

Ports: 10-32(M5)

Material: Brass

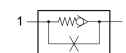

Adjustable Exhaust Flow Control

47200

Flow full open: 3.85 CFM @ 100 PSI
1.65 CFM @ 45 PSI

Dimensions: 9/16" L x 1/4" Hex.

Thread: M5

Material: Brass

For direct mounting on exhaust ports. Adjustable, equipped with locking nut to prevent tampering or loosening after setting is made.



Adjustable Flow Control

Brass **47220**

Brass nickel plated **47220-01**

Flow full open: 2 CFM @ 100 PSI
.85 CFM @ 45 PSI

Dimensions: 1 5/8" H x 1/2" Hex.

Ports: M5

Material: Brass

Needle valve type flow control for direct mounting or panel mounting through a 5/16" dia. hole. Equipped with mounting nut. The knurled adjustment knob for fine adjustment has screw driver slot and shaft is equipped with locking nut to prevent tampering after proper setting is made.



Adjustable One Way Flow Control

47370

Flow full open: 2.5 CFM @ 100 PSI.
1 CFM @ 45 PSI.

Check Valve: Opens at 7 PSI.

Dimensions: 1 5/8" H x 1" W x 3/8" D.

Through Body Mounting Holes:
1/8" dia. on 11/16" centers.

Housing: Zinc alloy.

Ports: 10-32 (M5)

Finger adjustable via knurled knob equipped with screw slot. Has lock nut to lock adjustment. Can be mounted with screws through body or panel mounted through a 1/4" dia. hole.

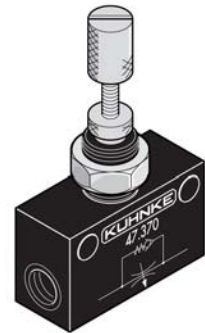

Brass Adjustable One Way Flow Control

47255

Flow full open: 2.7 CFM @ 100 PSI.
1.2 CFM @ 45 PSI.

Check Valve: Opens at 7 PSI.

Dimensions: 1 7/8" H x 7/8" W x 1/2" D.

Through Body Mounting Holes:
1/8" dia. on 1 9/32" centers.

Housing: Brass

Ports: 10-32 (M5)

Finger adjustable via knurled knob equipped with screw slot. Has lock nut to lock adjustment. Can be mounted with screws through body or panel mounted through a 1/4" dia. hole.



Logic Valves and Flow Controls

Series 47

Kuhnke System Logic Devices

Push-In Fittings with One Way Adjustable Flow Controls



For Inlet Ports:

47076 – 4x1 mm tubing, M5 thread

47091 – 6x1mm tubing, G1/8 thread

For Exhaust Ports:

47075 – 4x1 mm tubing, M5 thread

47090 – 6x1mm tubing, G1/8 thread

For direct mounting on cylinder or valve ports, with L-banjo type instant push-in fitting and captive adjusting screw.

Flow Full Open:

M5 - 3.35 CFM @ 100 PSI

1.4 CFM @ 45 PSI

G1/8 - 3.1 CFM @ 100 PSI

1.3 CFM @ 45 PSI

Dimensions:

M5- 13/16" H x 1/4" W x 7/8" H

G1/8- 1 1/4" H x 9/16" W x 13/8" H



Inlet



Exhaust

Barbed Fittings with One Way Adjustable Flow Controls

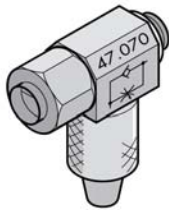

For Inlet Ports:

47071 - 5x1mm tubing, M5 thread

47081 - 6x1mm tubing, M5 thread

47086 - 6x1mm tubing, G1/8 thread

For Exhaust Ports:

47070 - 5x1mm tubing, M5 thread

47080 - 6x1mm tubing, M5 thread

47085 - 6x1mm tubing, G1/8 thread

For direct mounting on valve or cylinder ports, with captive adjusting screw and L-banjo type barb fitting.

Flow Full Open:

M5 - 3.35 CFM @ 100 PSI

1.4 CFM @ 45 PSI

G1/8 - 3.1 CFM @ 100 PSI

1.3 CFM @ 45 PSI

Dimensions:

M5- 13/16" H x 1/4" W x 7/8" H

G1/8- 1 1/4" H x 9/16" W x 1 3/8" H



Inlet



Exhaust

Accessories for Flow Controls

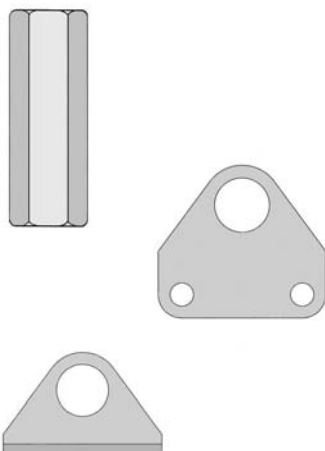

47266 Protective Cover

Brass cover can be used to cap off adjustable flow controls, preventing tampering after adjustment is set.

Dimensions: 1 3/16" H x 3/8" Hex.

38305 Flat Mounting Bracket

38306 L Shaped Mounting Bracket

Used to mount flow controls. Made from zinc plated sheet steel. Mounting holes are 1/8" dia. on 11/16" centers. "L" Bracket has a 3/8" return flange.

Dimensions:

Flat - 15/16" H x 1" W.

L shape - 5/8 H. x 1" W x 3/8" D